



5000W

SGM7S-330A30A



一般



煞車



驱动器尺寸

SGM7A-55A3A2E

SGM7A-55A3A2E

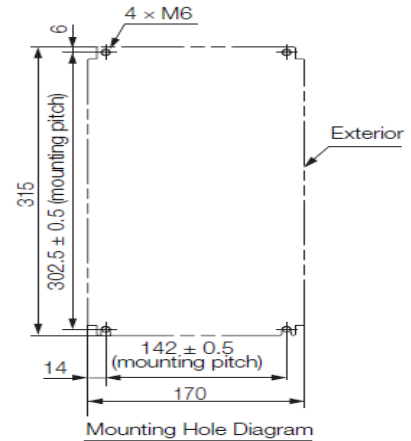
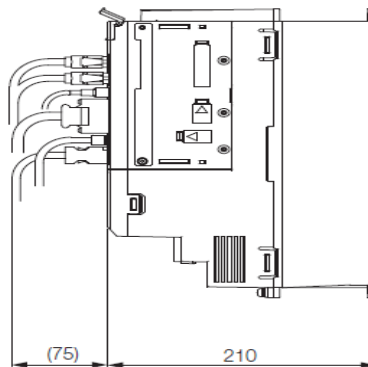
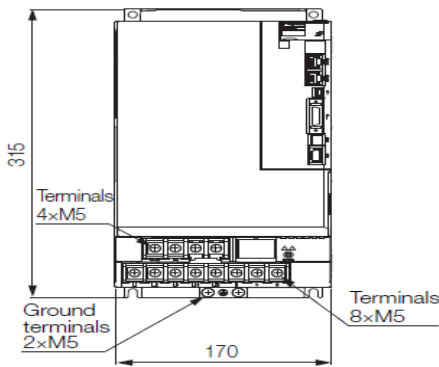

Approx. Mass: 8.2 kg  
 Unit: mm

型号 SGM7S-		R70A	R90A	1R6A	2R8A	3R8A	5R5A	7R6A	120A	180A	200A	330A	
最大适用电机容量 [kW]		0.05	0.1	0.2	0.4	0.5	0.75	1.0	1.5	2.0	3.0	5.0	
连续输出电流 [Arms]		0.66	0.91	1.6	2.8	3.8	5.5	7.6	11.6	18.5	19.6	32.9	
瞬时最大输出电流 [Arms]		2.1	3.2	5.9	9.3	11	16.9	17	28	42	56	84.0	
主回路	电源	AC200 ~ 240V、-15% ~ +10%、50/60Hz											
	输入电流 [Arms]*	0.4	0.8	1.3	2.5	3.0	4.1	5.7	7.3	10	15	25	
控制电源		AC200 ~ 240V、-15% ~ +10%、50/60Hz											
电源容量 [kVA]*		0.2	0.3	0.5	1.0	1.3	1.6	2.3	3.2	4.0	5.9	7.5	
电能损耗*	主回路电能损耗 [W]	5.1	7.3	13.5	24.0	20.1	43.8	53.6	65.8	111.9	113.8	263.7	
	控制回路电能损耗 [W]	17	17	17	17	17	17	17	22	22	22	27	
	内置再生电阻电能损耗 [W]	-	-	-	-	8	8	8	10	16	16	36.0	
	合计电能损耗 [W]	22.1	24.3	30.5	41.0	45.1	68.8	78.6	97.8	149.9	151.8	326.7	
再生电阻器	内置再生电阻器	电阻值 [Ω]	-	-	-	-	40	40	40	20	12	12	8
		容量 [W]	-	-	-	-	40	40	40	60	60	60	180
	外置最小容许电阻值 [Ω]	40	40	40	40	40	40	40	20	12	12	8	
过电压等级		III											



SUN CNC華勝自動化有限公司 台中市豐原區社皮里豐原大道一段428巷22弄90號

http://www.sun-cnc.com.tw

TEL:04-25337731

E-mail:sn@sun-cnc.com.tw

FAX:04-25349224

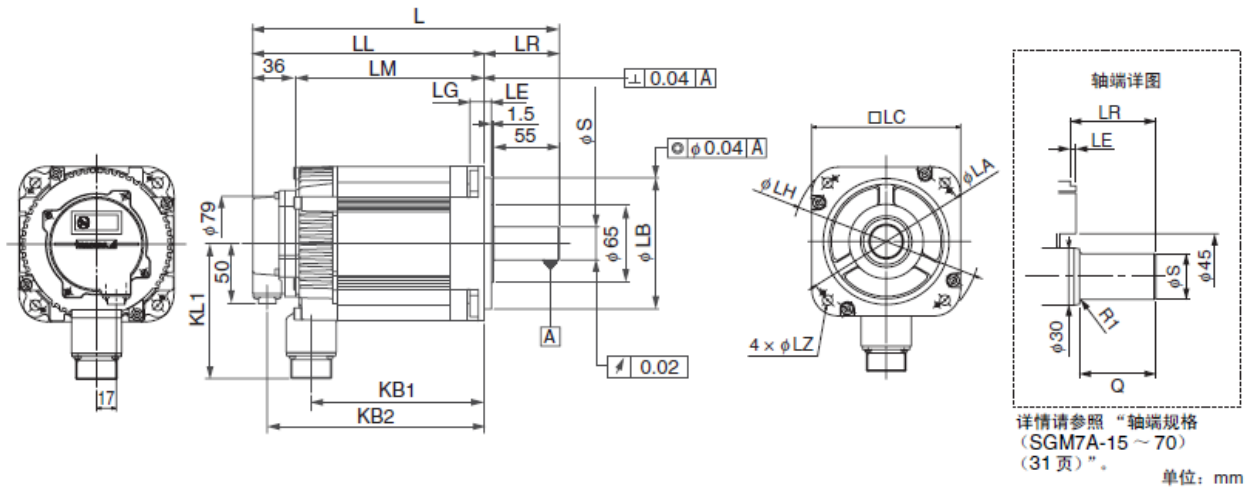

型号 SGM7A-	L	LL	LM	LR	KB1	KB2	KL1
30A□A2S	257	194	158	63	145	182	114
40A□A2S	296	233	197	63	184	221	114
50A□A2S	336	273	237	63	224	261	114

型号 SGM7A-	法兰尺寸							轴端尺寸		大致质量 [kg]
	LA	LB	LC	LE	LG	LH	LZ	S	Q	
30A□A2S	145	110 <sup>0</sup> <sub>-0.035</sub>	130	6	12	165	9	28 <sup>0</sup> <sub>-0.013</sub>	55	10.5
40A□A2S	145	110 <sup>0</sup> <sub>-0.035</sub>	130	6	12	165	9	28 <sup>0</sup> <sub>-0.013</sub>	55	13.5
50A□A2S	145	110 <sup>0</sup> <sub>-0.035</sub>	130	6	12	165	9	28 <sup>0</sup> <sub>-0.013</sub>	55	16.5

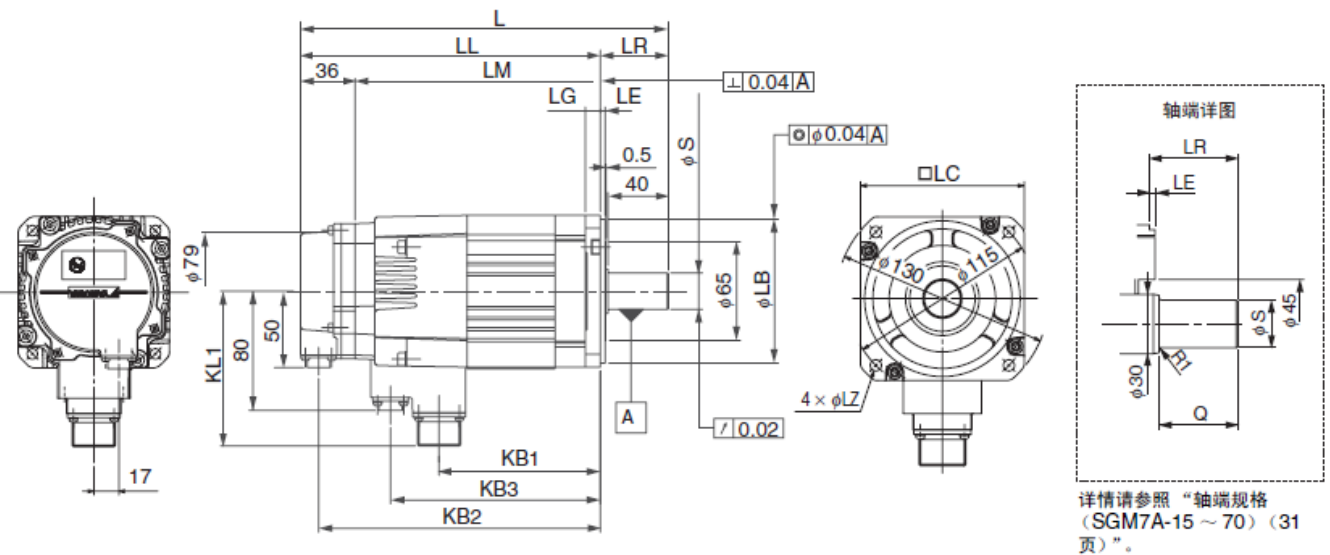

型号 SGM7A-	L	LL	LM	LR	KB1	KB2	KB3	KL1
50A□A2E	372	309	273	63	224	297	260	119

  

型号 SGM7A-	法兰面尺寸							轴端尺寸		大致质量 [kg]
	LA	LB	LC	LE	LG	LH	LZ	S	Q	
50A□A2E	145	110 <sup>0</sup> <sub>-0.035</sub>	130	6	12	165	9	28 <sup>0</sup> <sub>-0.013</sub>	55	19



Voltage		200 V						
Model SGM7A-		15A	20A	25A	30A	40A	50A	70A
Rated Output <sup>15</sup>	kW	1.5	2.0	2.5	3.0	4.0	5.0	7.0
Rated Torque <sup>2, 16</sup>	N·m	4.90	6.36	7.96	9.80	12.6	15.8	22.3
Instantaneous Maximum Torque <sup>16</sup>	N·m	14.7	19.1	23.9	29.4	37.8	47.6	54.0
Rated Current <sup>16</sup>	Arms	9.3	12.1	15.6	17.9	25.4	27.6	38.3
Instantaneous Maximum Current <sup>16</sup>	Arms	28	42	51	56	77	84	105
Rated Motor Speed <sup>16</sup>	min <sup>-1</sup>	3000						
Maximum Motor Speed <sup>16</sup>	min <sup>-1</sup>	6000 <sup>18</sup>						
Torque Constant	N·m/Arms	0.590	0.561	0.538	0.582	0.519	0.604	0.604
Motor Moment of Inertia	×10 <sup>-4</sup> kg·m <sup>2</sup>	2.00 (2.25)	2.47 (2.72)	3.19 (3.44)	7.00 (9.20)	9.60 (11.8)	12.3 (14.5)	12.3
Rated Power Rate <sup>16</sup>	kW/s	120 (106)	164 (148)	199 (184)	137 (104)	165 (134)	203 (172)	404
Rated Angular Acceleration Rate <sup>16</sup>	rad/s <sup>2</sup>	24500 (21700)	25700 (23300)	24900 (23100)	14000 (10600)	13100 (10600)	12800 (10800)	18100
Heat Sink Size (Aluminum)	mm	300 × 300 × 12			400 × 400 × 20			
Protective Structure <sup>3</sup>	Totally enclosed, self-cooled, IP67							Totally enclosed, separately cooled (with fan), IP22
Holding Brake Specifications <sup>14</sup>	Rated Voltage	V	24 VDC <sup>+10%</sup> <sub>0</sub>					
	Capacity	W	12			10		
	Holding Torque	N·m	7.84		10		20	
	Coil Resistance	Ω (at 20°C)	48			59		
	Rated Current	A (at 20°C)	0.5			0.41		
	Time Required to Release Brake	ms	170			100		
	Time Required to Brake	ms	80					
Allowable Load Moment of Inertia (Motor Moment of Inertia Ratio)	10 times			5 times				
Allowable Shaft Loads <sup>15</sup>	LF	mm	45			63		
	Allowable Radial Load	N	686			980		1176
	Allowable Thrust Load	N	196			392		

### T-N 曲線

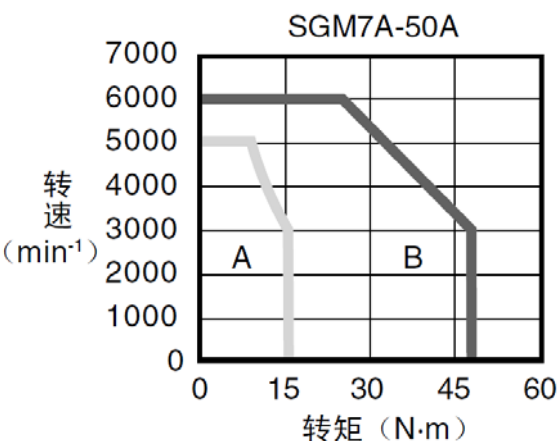

Shaft End Details	Servo Motor Model SGM7A-					
	15	20	25	30	40	50
Code: 2 (Straight without Key)						
	LR	45			63	
	Q	40			55	
	S	24 <sup>0</sup> <sub>-0.013</sub>			28 <sup>0</sup> <sub>-0.013</sub>	
Code: 6 (Straight with Key and Tap)						
	LR	45			63	
	Q	40			55	
	QK	32			50	
	S	24 <sup>0</sup> <sub>-0.013</sub>			28 <sup>0</sup> <sub>-0.013</sub>	
	W	8				
	T	7				
	U	4				
P	M8 screw, Depth: 16					